

REV.	ECN	DESCRIPTION	DATE	DRAWN BY	APPROVED
00	-	ORIGINAL ISSUE - RND# 000073	11/1/22	CK	DF
01	ECN000906	ADDED Cv VALUES TO DIMENSION CHART	12/5/22	CK	DF

NO.	PART NAME	MATERIAL
1	BODY	A216 WCB
2	SEAT RING	ASTM A105+STL
3	DISC	A216 WCB+410
4	WASHER	304
5	DISC PIN	304
6	DISC NUT	A194 2H
7	HINGE	A216 WCB
8	PIN	A276 420
9	NAMEPLATE	A666 304
10	RIVET	A666 304
11	SEAL RING	A29 1008
12	COVER	A216 WCB
13	NUT	A194 2H
14	BOLT	A193 B7
15	EYEBOLT	AISI 1025
16	GASKET	304+GRAPHITE
17	PLUG	ASTM A105

SPECIFICATION:

*BASIC DESIGN: API 594

*END FLANGE: ASME B16.5

*FACE TO FACE: ASME B16.10

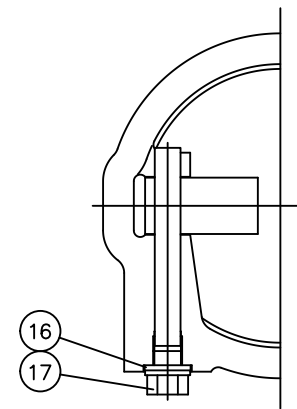
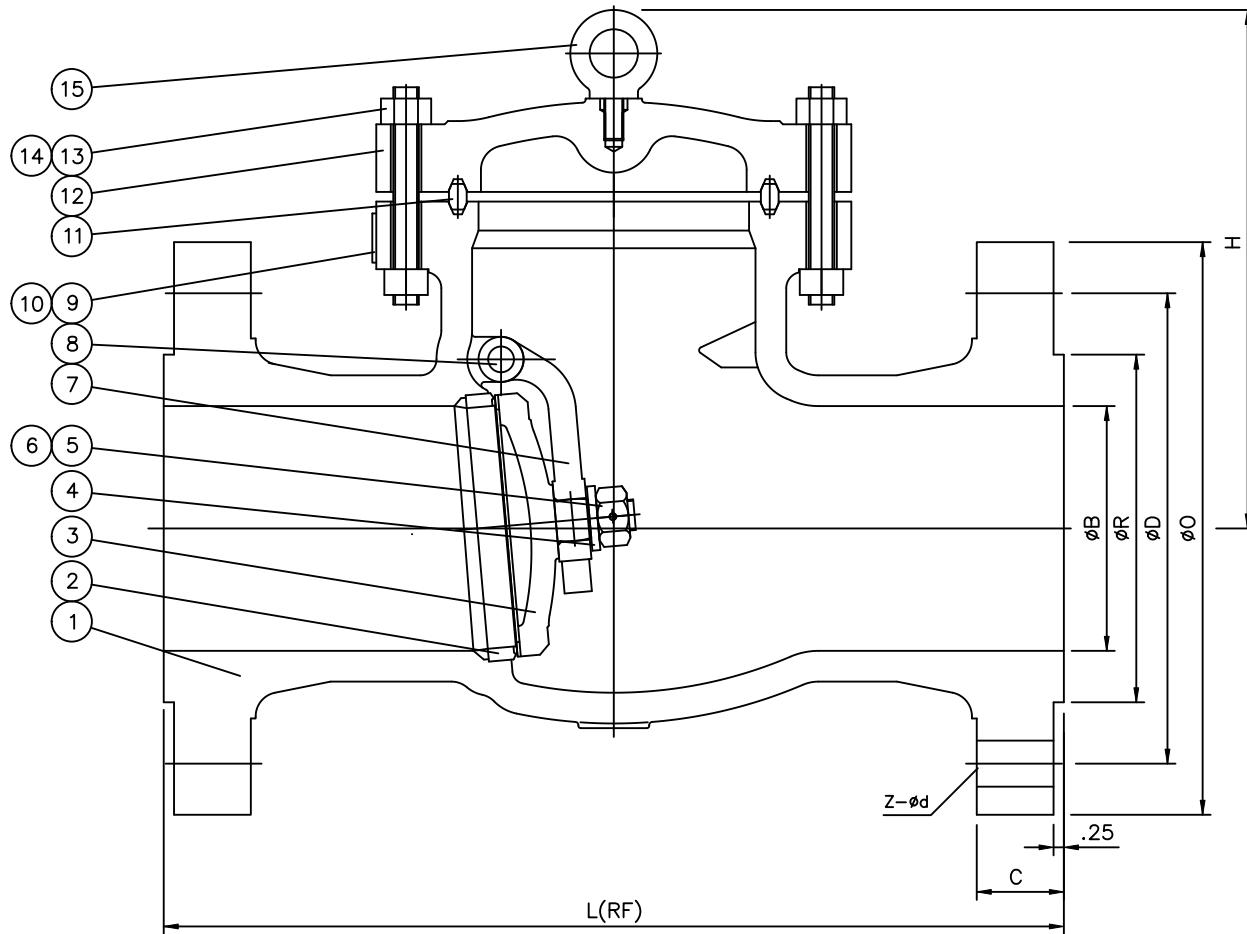

SIZE	DIXON P/N	øB	L(RF)	øO	øD	øR	C	Z-ød	H	WEIGHT	Cv
3"	D896008-300	3.00	14.00	8.25	6.62	5.00	1.25	8-0.87	7.60	97 LBS.	108.4
4"	D896008-400	4.00	17.00	10.75	8.50	6.19	1.50	8-1.00	10.08	176.4 LBS.	197.9
6"	D896008-600	6.00	22.00	14.00	11.50	8.50	1.88	12-1.13	12.68	337.3 LBS.	445.2
8"	D896008-800	8.00	26.00	16.50	13.75	10.62	2.19	12-1.25	15.24	648.2 LBS.	799.4



DIXON VALVE AND COUPLING COMPANY
6525 HOMESTEAD RD., HOUSTON, TX 77028, USA
(713) 678-4291 (877) 963-4966

CAST STEEL SWING CHECK VALVE
3",4",6",8" CLASS 600

SIZE A	DWG NO. D896008	REV 01
-----------	--------------------	-----------

5

4

3

2

1